

Installation Instructions: Type I Sidelite Door Frames



Tools Required: Tape Measure, Level, Plumb Bob, File, Rubber Mallet, Drill, Miter Saw with Carbide Tipped Blade

Field conditions may cause components to be modified to fit. Cutting and notching is to be expected with installation.

Parts List

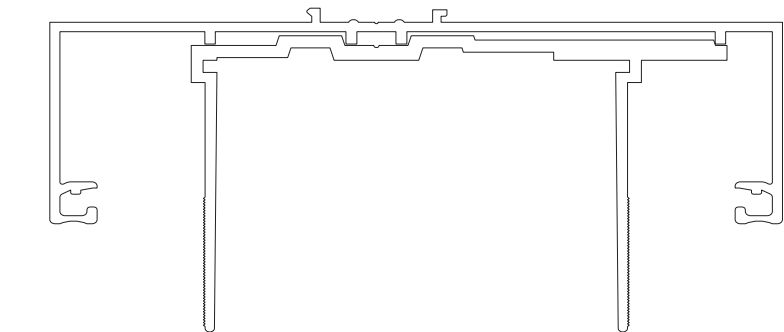

Hinge Jamb Assembly

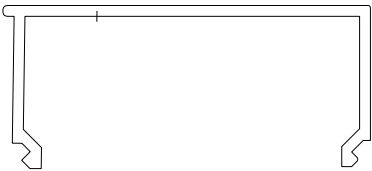

Glass Stop

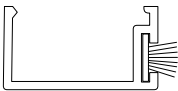

Door Stop

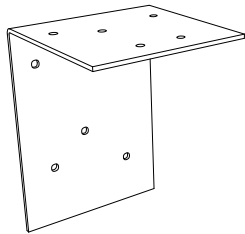

C400ST Angle Clip

#8 x 1/2" Self Drilling Wafer Head Screws

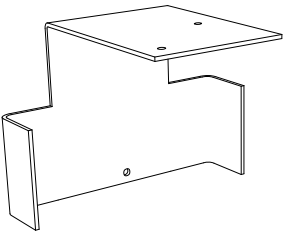

C408ST Header Clip

2 ea. #10x5/8" TEK Screws

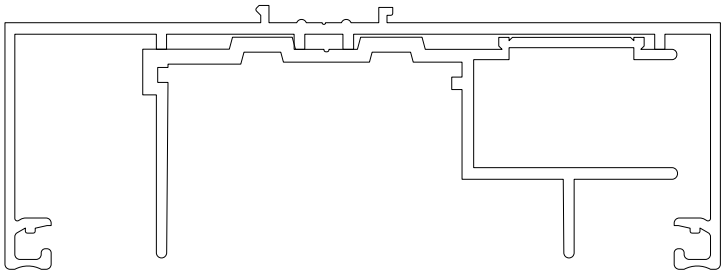
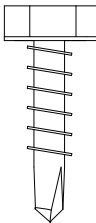

Strike Jamb Assembly



Glazing Vinyl

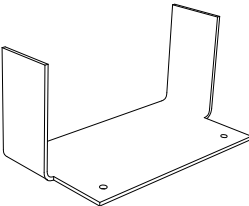

C410ST Floor Clip

#6 x 1-5/8" Flat Head Drywall Screws

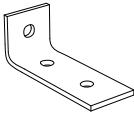
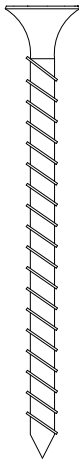

C406ST Mini Clip

Parts List

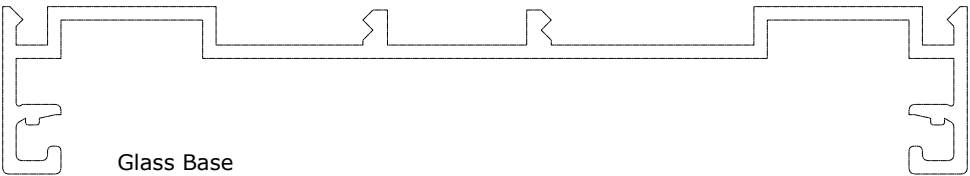

Glass Base

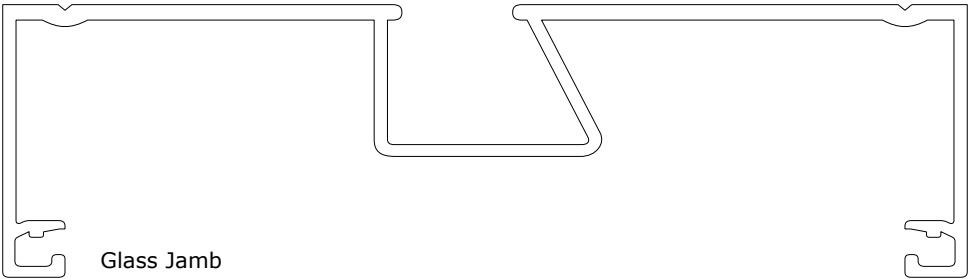

Glass Jamb

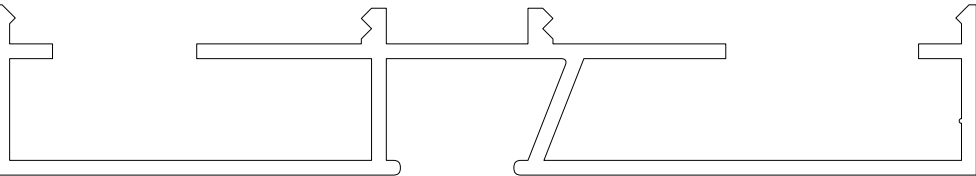

Mid-Height Base (If Required)



H-mullion

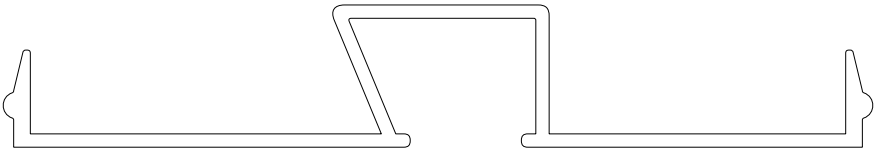

Snap-in Glass Pocket

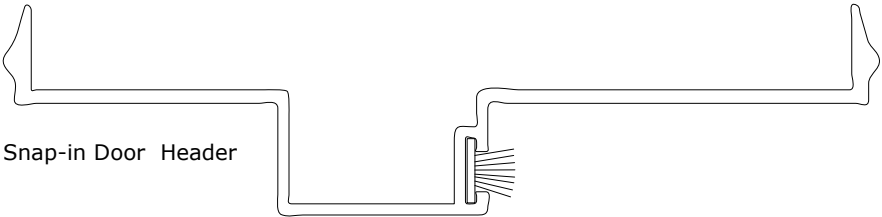

Snap-in Door Header

Step 1

Check dimensions and square of rough opening.
Cut vertical jamba if necessary.

*Frames may be shipped with extra length for field cutting to allow for floor deflections.

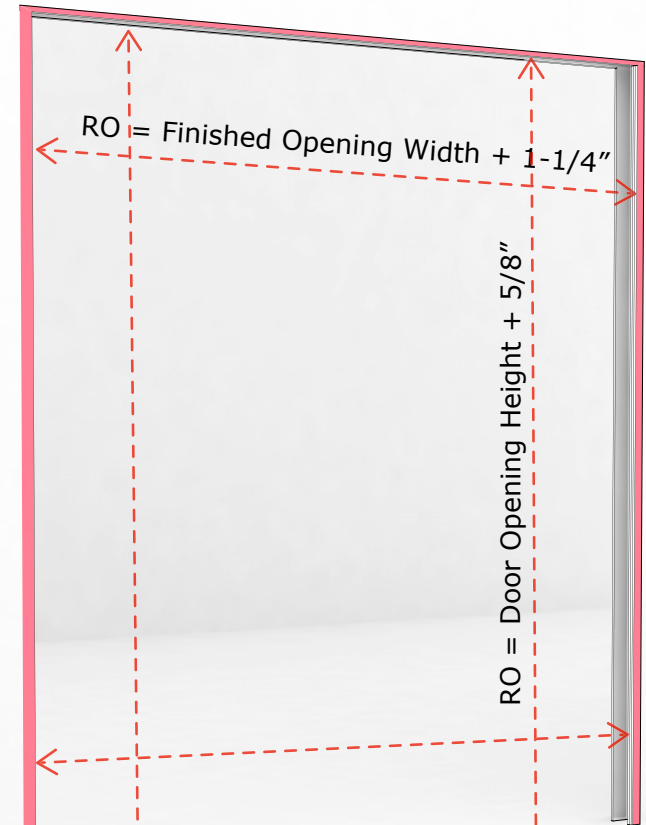
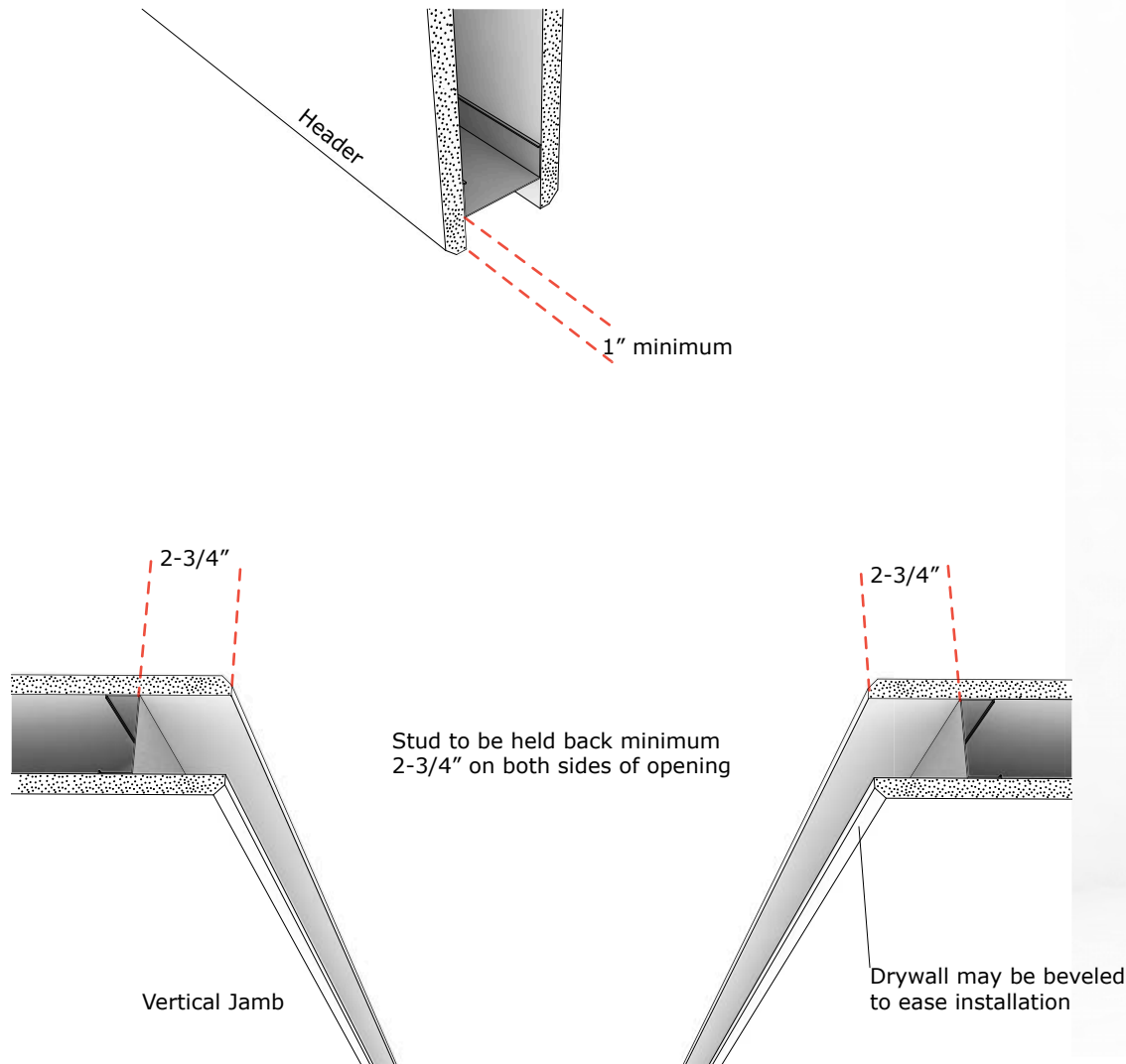

Step 2

Slip H-Mullion Header and Vertical Jambs into Opening and attach together.

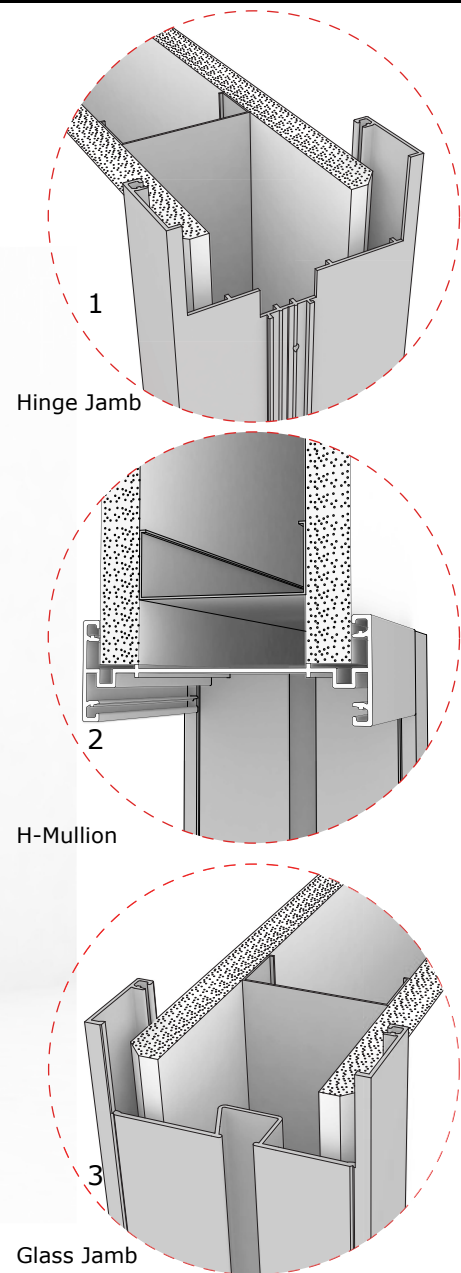
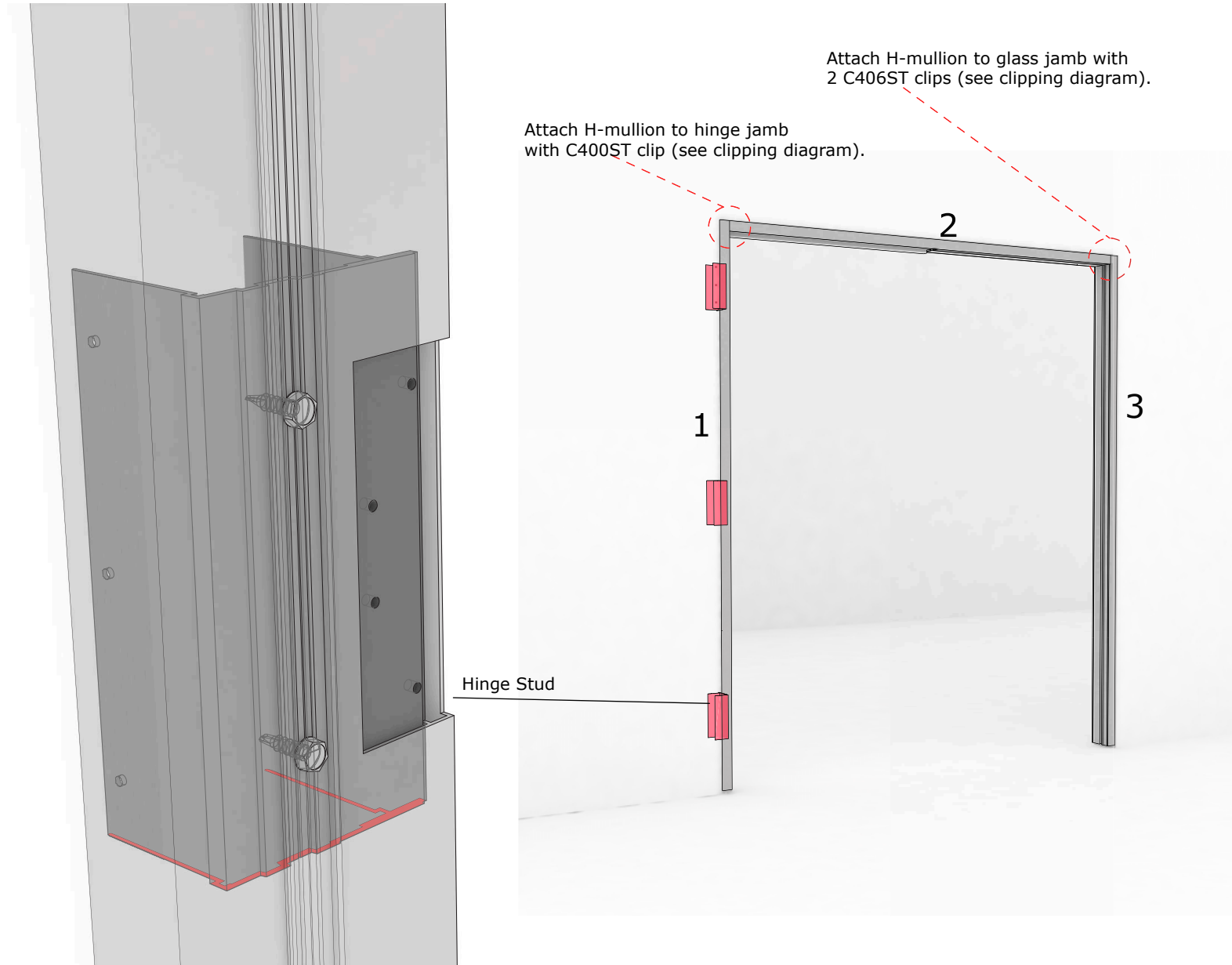

Step 3

Install snap-in header, followed by the strike jamb.

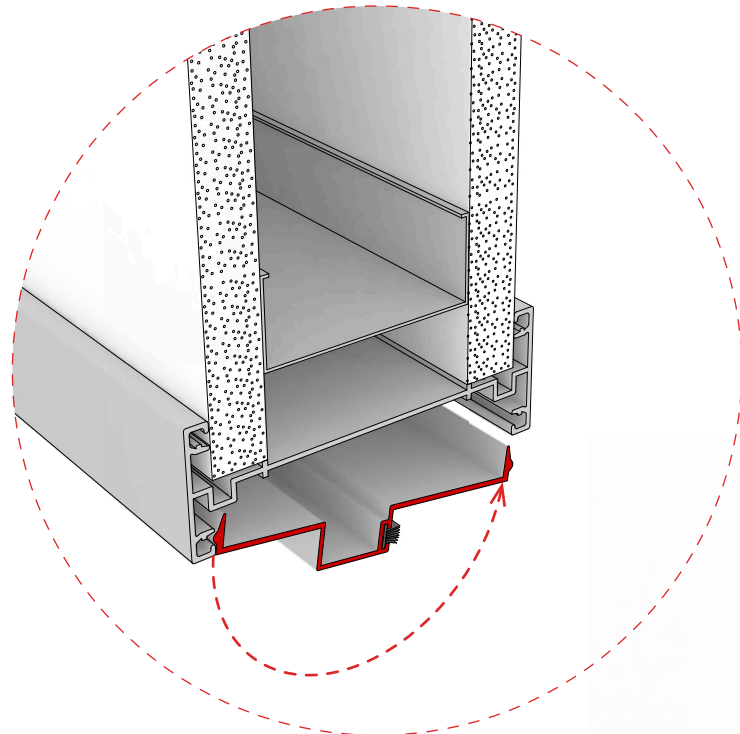

Install snap in door header

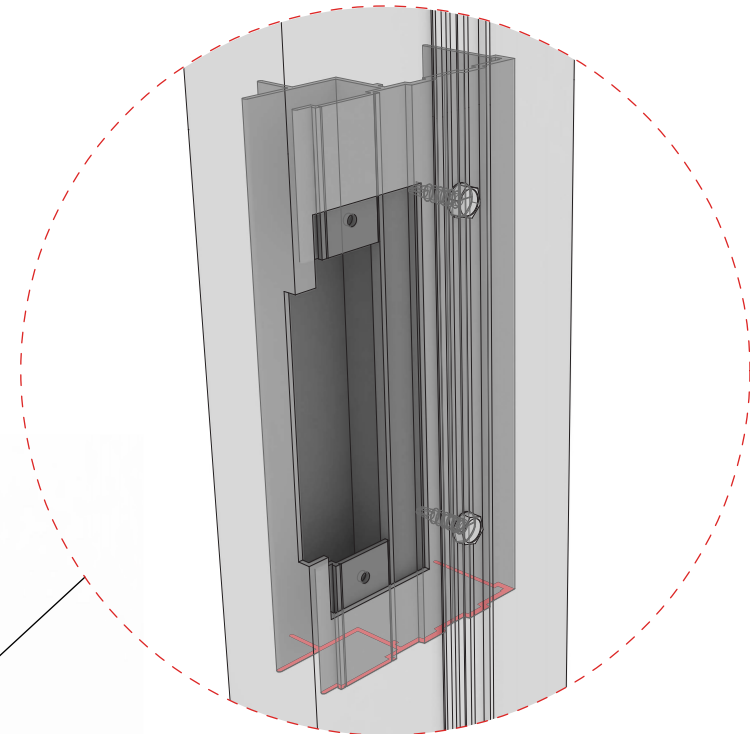

When installing the strike jamb, be sure to hold finished door opening width and secure to H-Mullion header with C408ST clip. Secure the strike jamb to the floor with the C410ST clip (reference clipping diagram.)

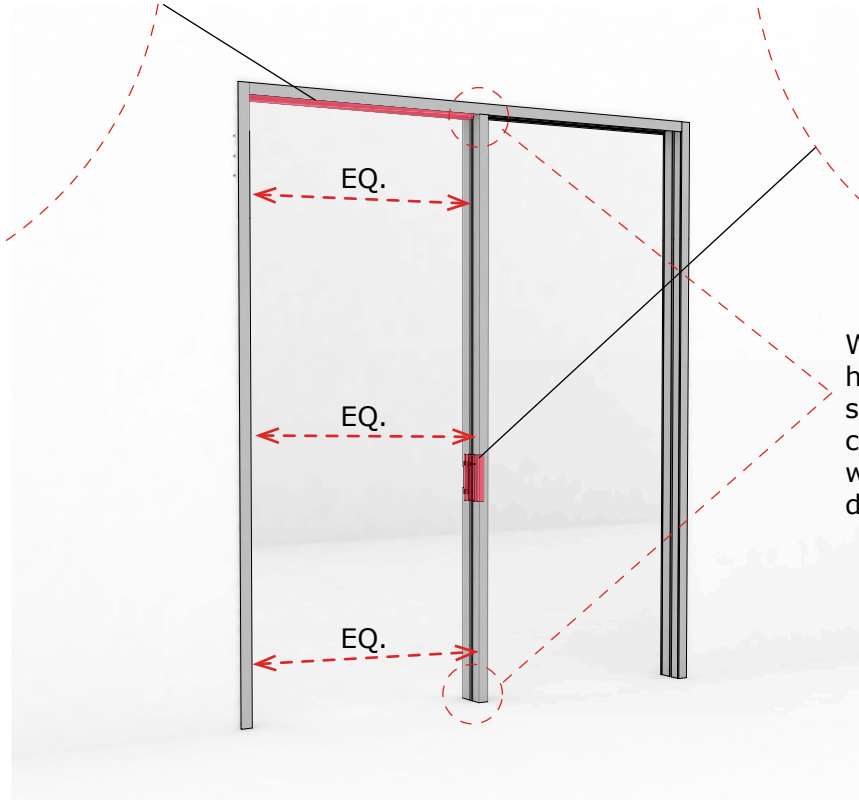

Step 4

Install glass pocket in strike jamb, followed by the glass base.

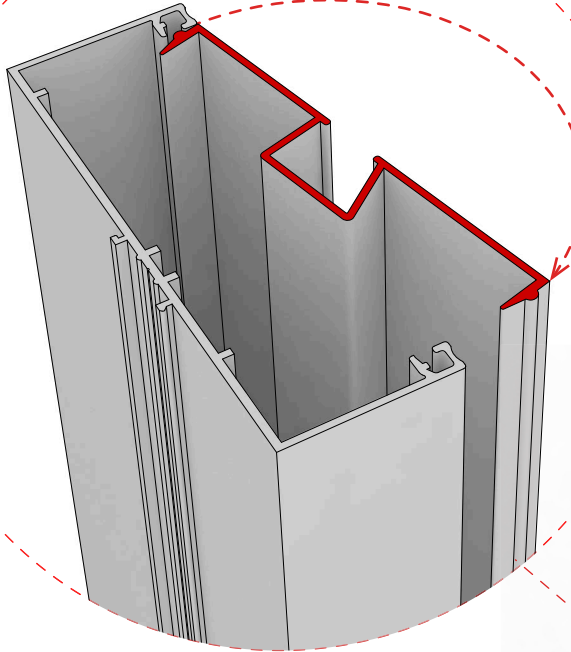

The glass pocket snaps into the open side of the strike jamb

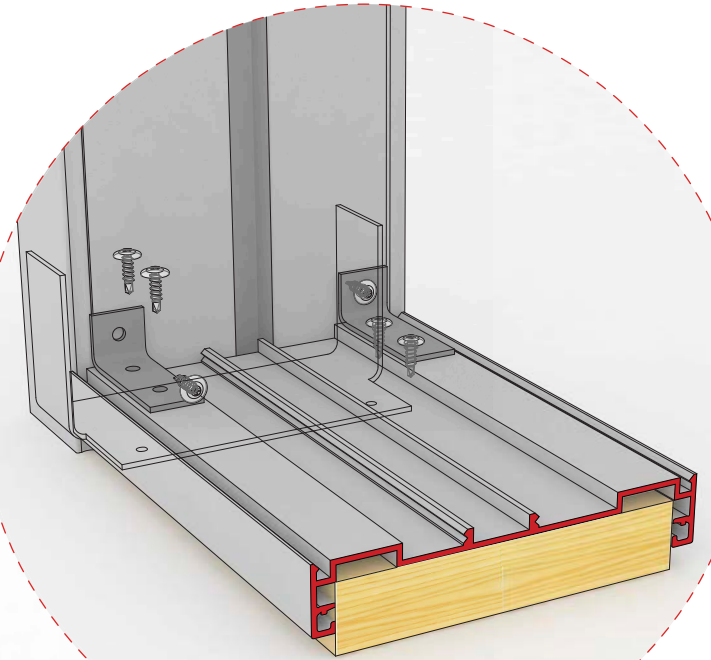

The glass base is installed between the strike jamb and glass jamb using the C406St clips (refer to clipping diagram.) This typically sets on 3/4" plywood which is supplied by others.

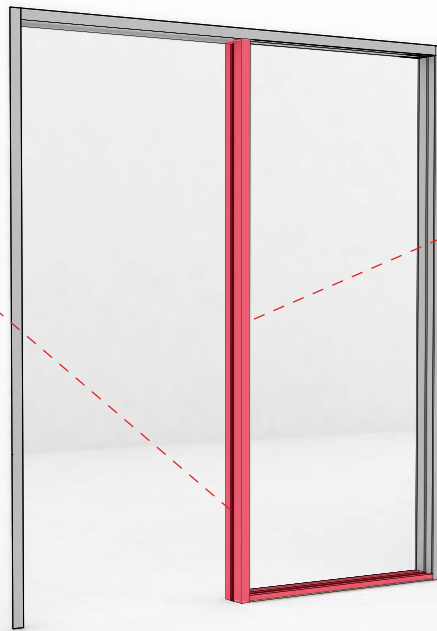

Step 5

Install intermediate vertical glass jamb (if required) and secure to glass base and H-mullion with 4 each C406ST clips (refer to clipping diagram.) Insert glass pocket in glass jamb followed by glass pocket headers into the H-mullion.

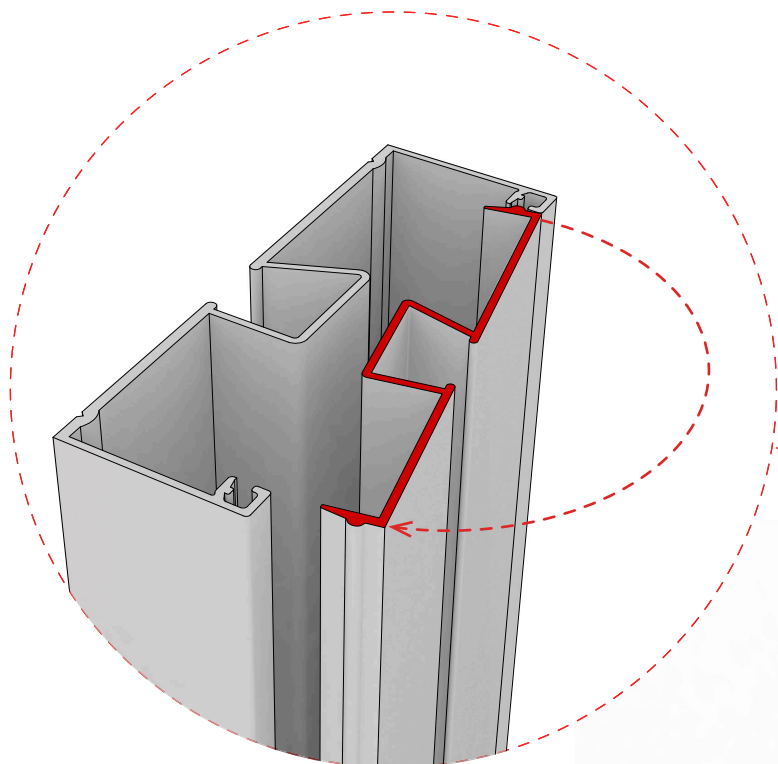

Snap glass pocket into vertical glass jamb.

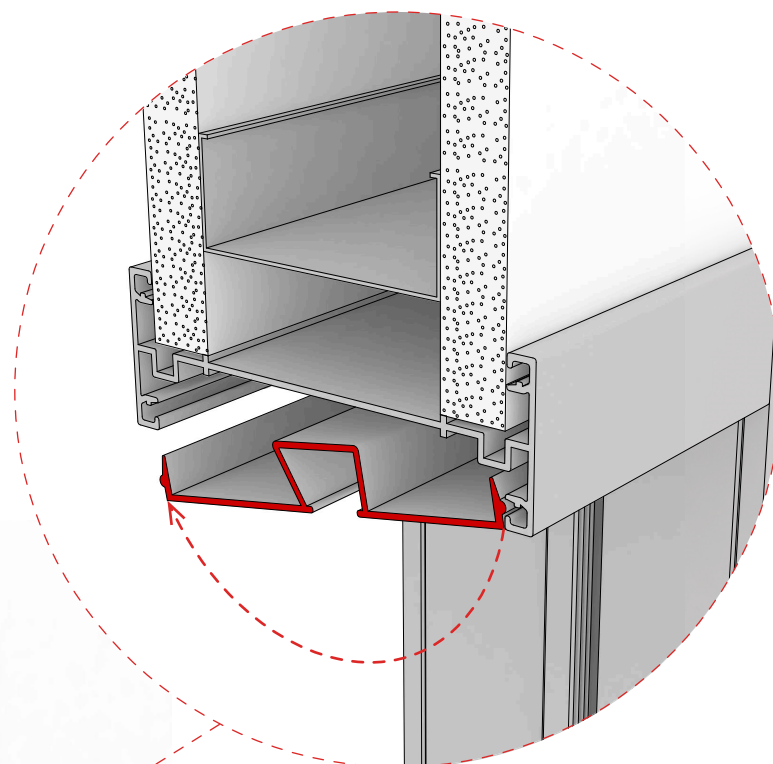

Snap glass pocket into H-mullion header.



Step 6

Install mid-height glass base (if required) with four C406ST clips (reference clipping diagram.) Install glass stops on glass base and midheight base.

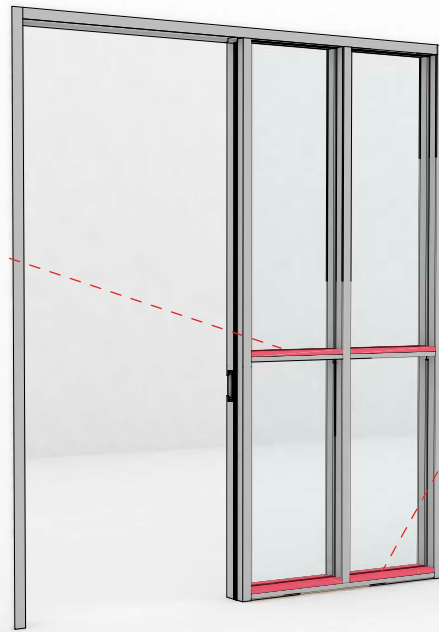
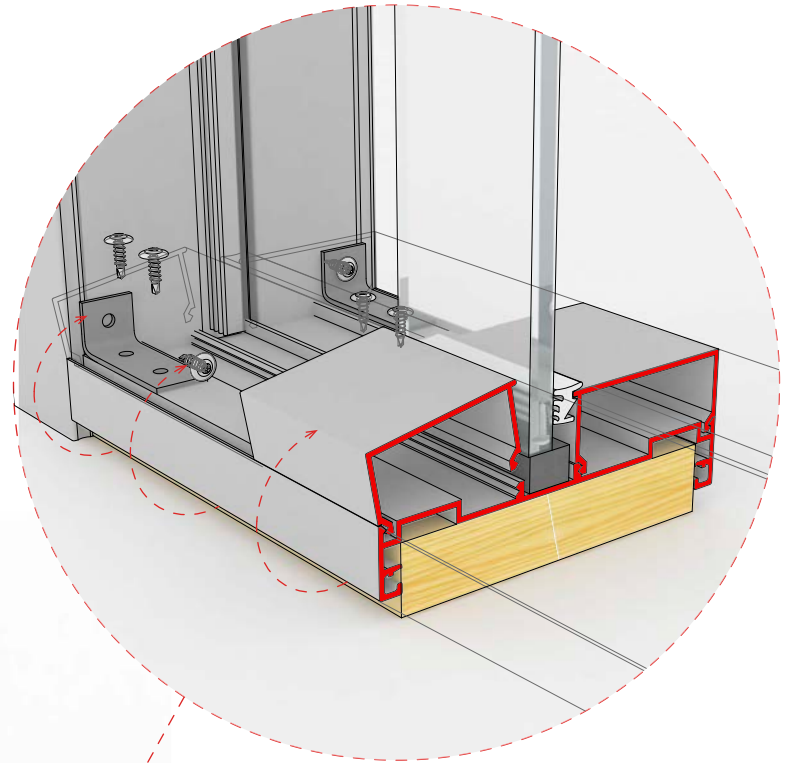
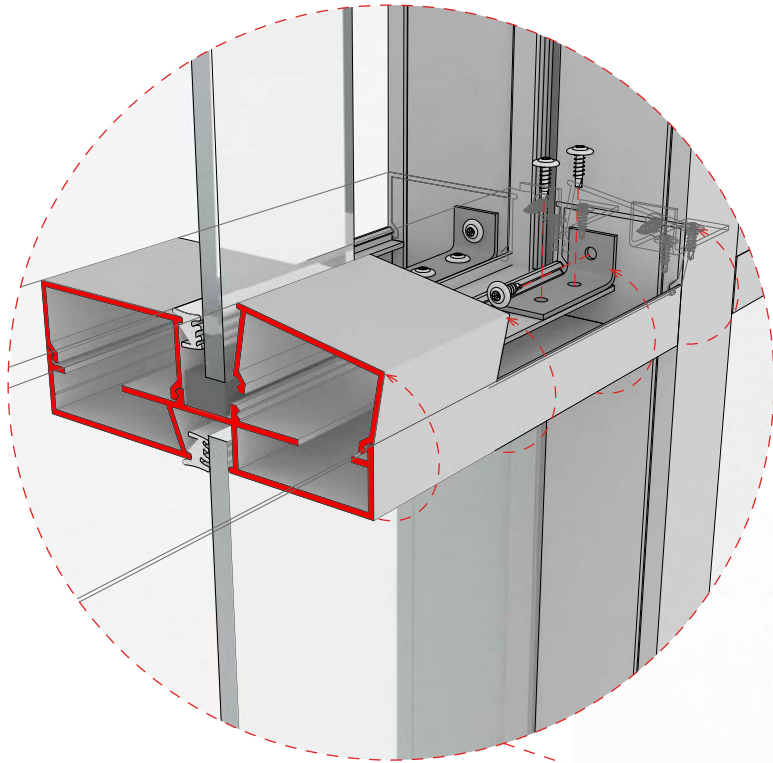

Step 7

Attach hinge jamb to drywall partition, then install door stops to hinge and strike jamb.

Attach hinge jamb with 1-5/8" drywall screws through the sheetrock and into the segmented frame stud. Use a minimum of 3 screws per stud segment per side.

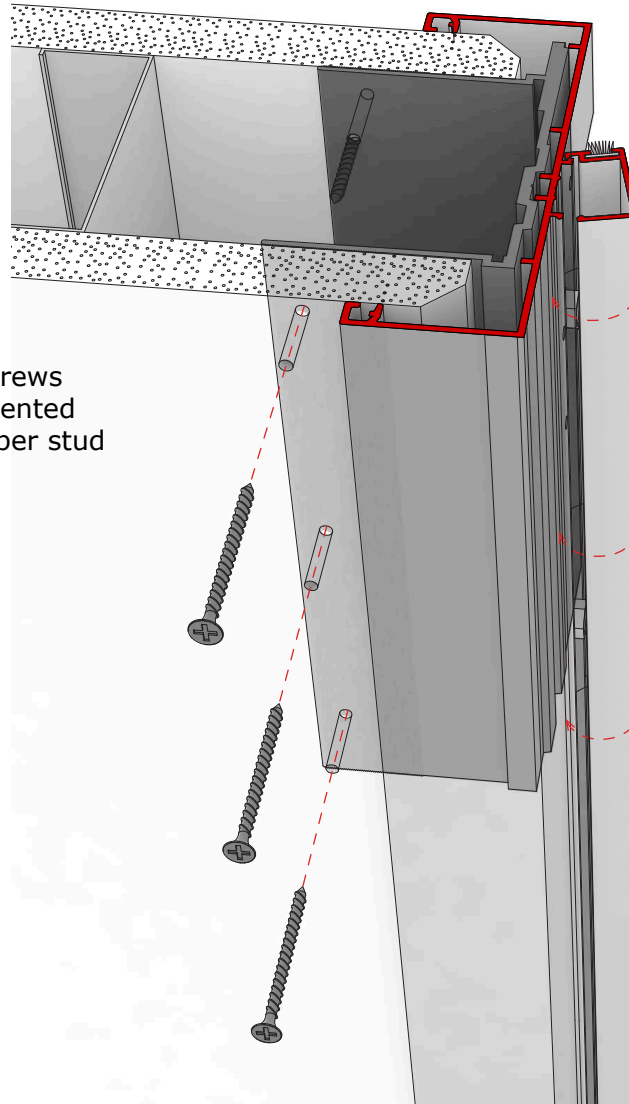

Attach door stops to hinge and strike jambs by hooking inside leg (nearest door) on receiver tab and lightly tap with rubber mallet toward outer edge of stop.