

Type II Clipping Diagram

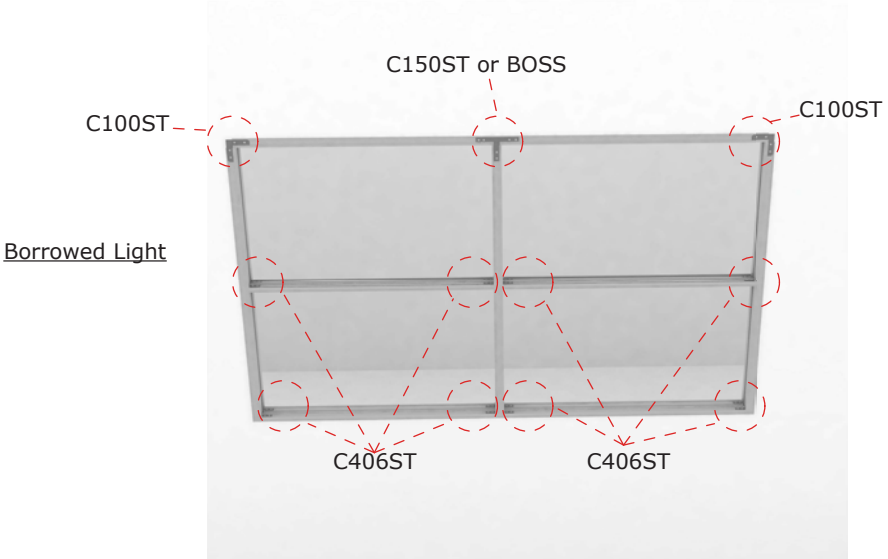

C100ST Clip

Use the C100ST clip to attach outside vertical jambs to a header with four 1/2" tek screws. This clip helps to ensure the opening is plumb and square. The header should sit on top of the vertical jamb and overlap the jamb by 3/8".

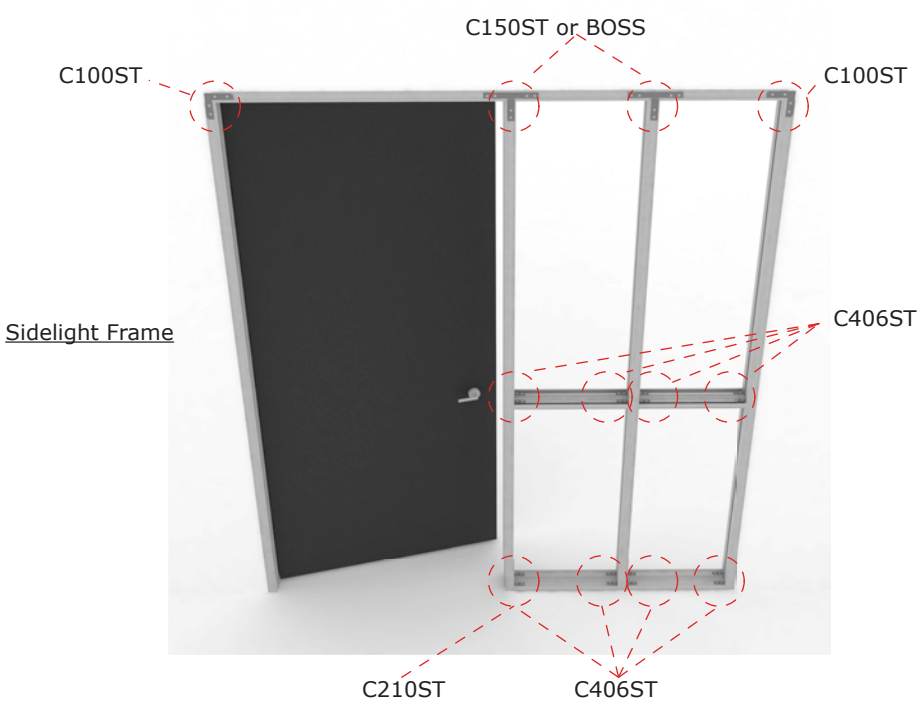
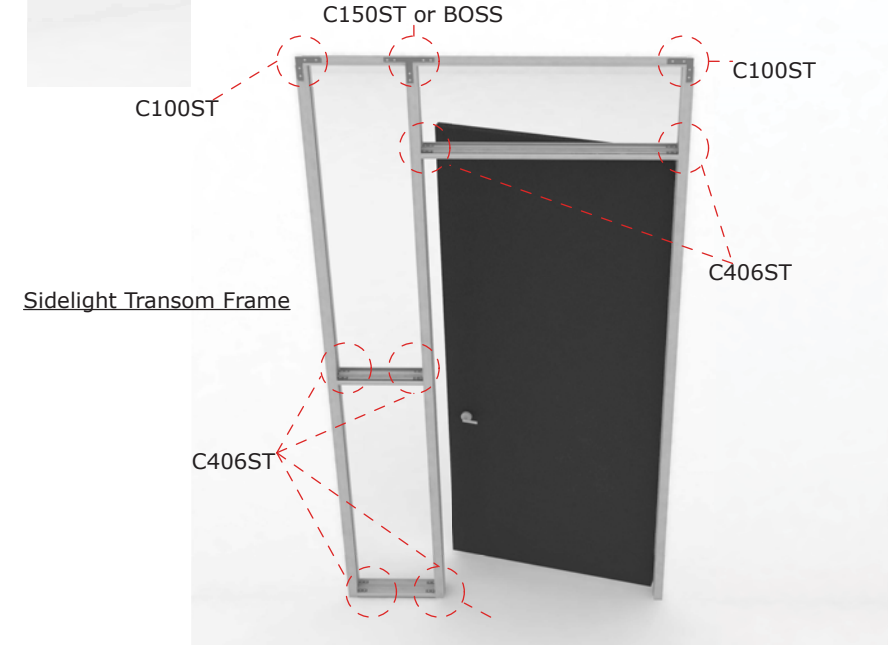
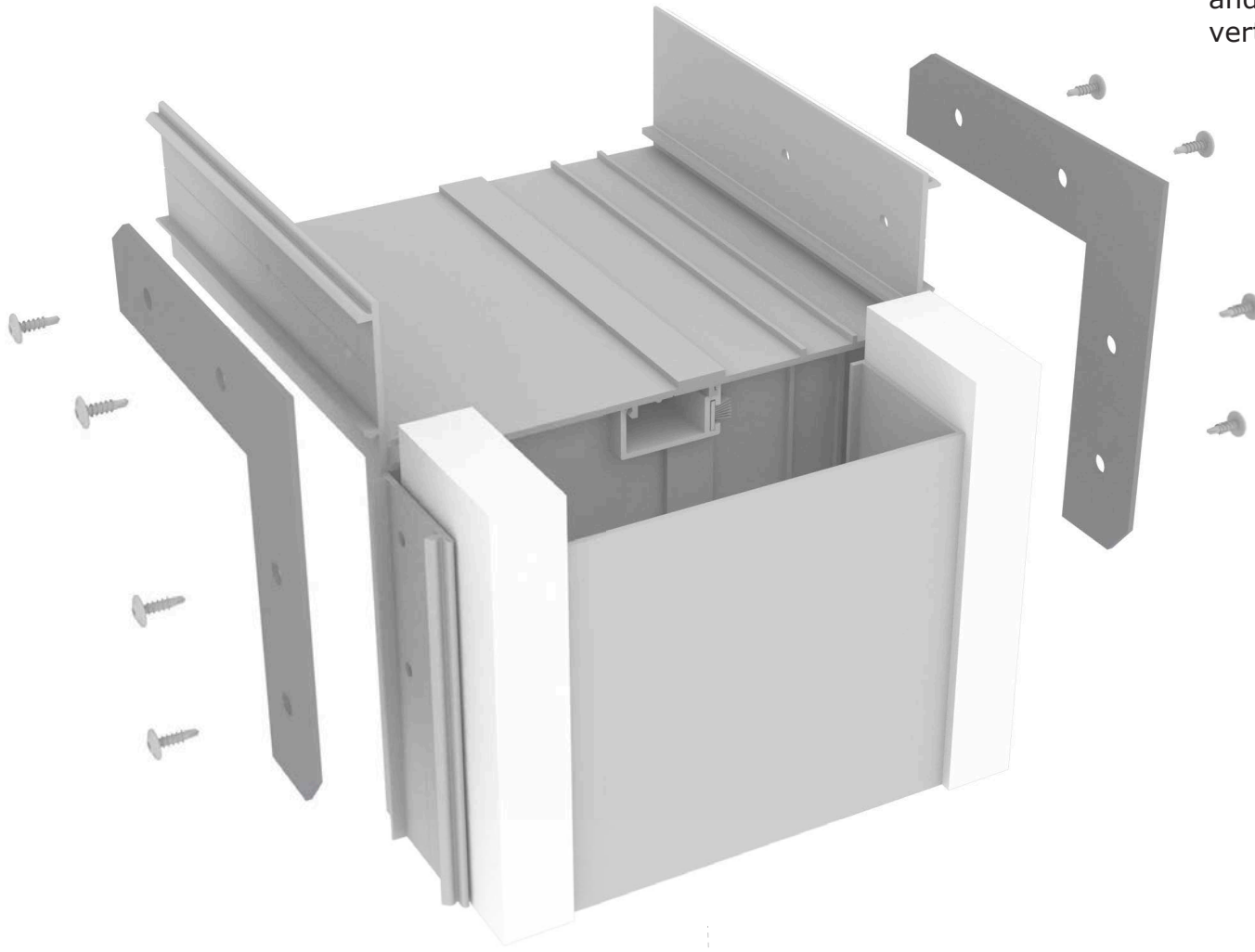

C150ST Clip

Use the C150ST clip ("T" clip) to attach an intermediate vertical mullion to a header with six 1/2" tek screws. Using this clip requires the header trim to be notched to bypass the clip.

*The BOSS clip can be used as an alternative to the "T" clip and does not require notching the trim.

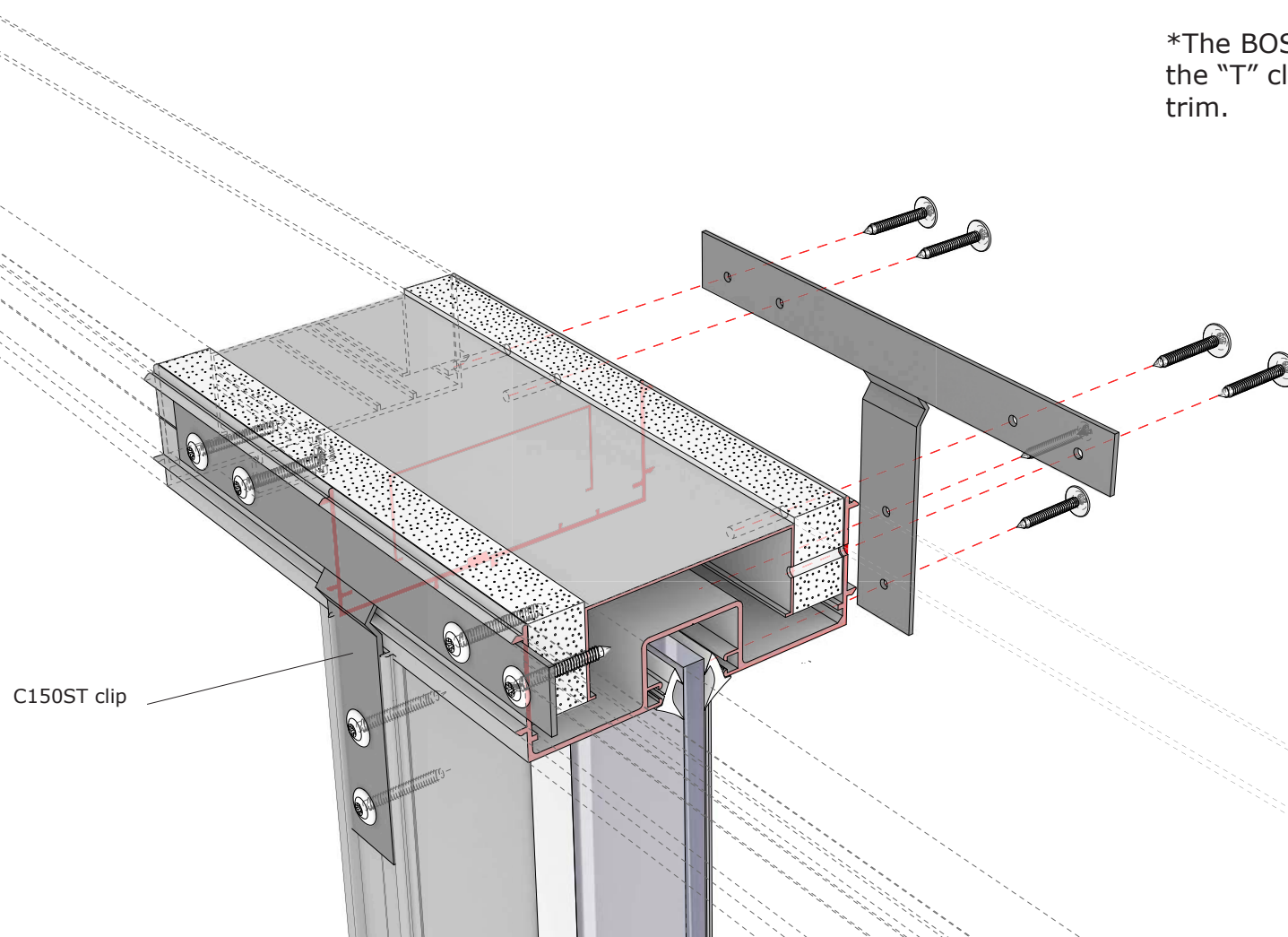

BOSS Clip

Strike Jamb/Glass Pocket Mullion (door header overlaps vertical jamb 3/8")

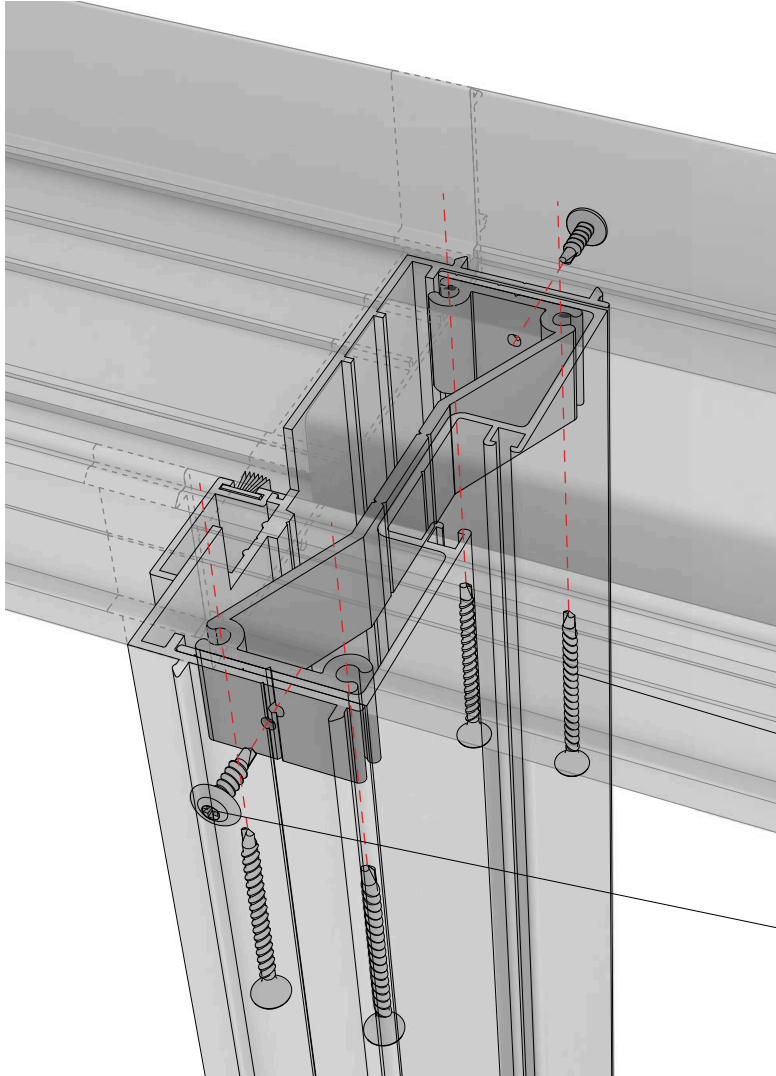

Locate the position of the BOSS clip and attach to the head condition using the provided #8 x 1-5/8" flat head self drilling screws (4 required for each clip.)

Once the BOSS clip is secured to the head, install components making up the vertical mullion and attach both parts to the BOSS clip using 1/2" tek screw on both sides of the mullion.

Glass Jamb/Glass Pocket Mullion

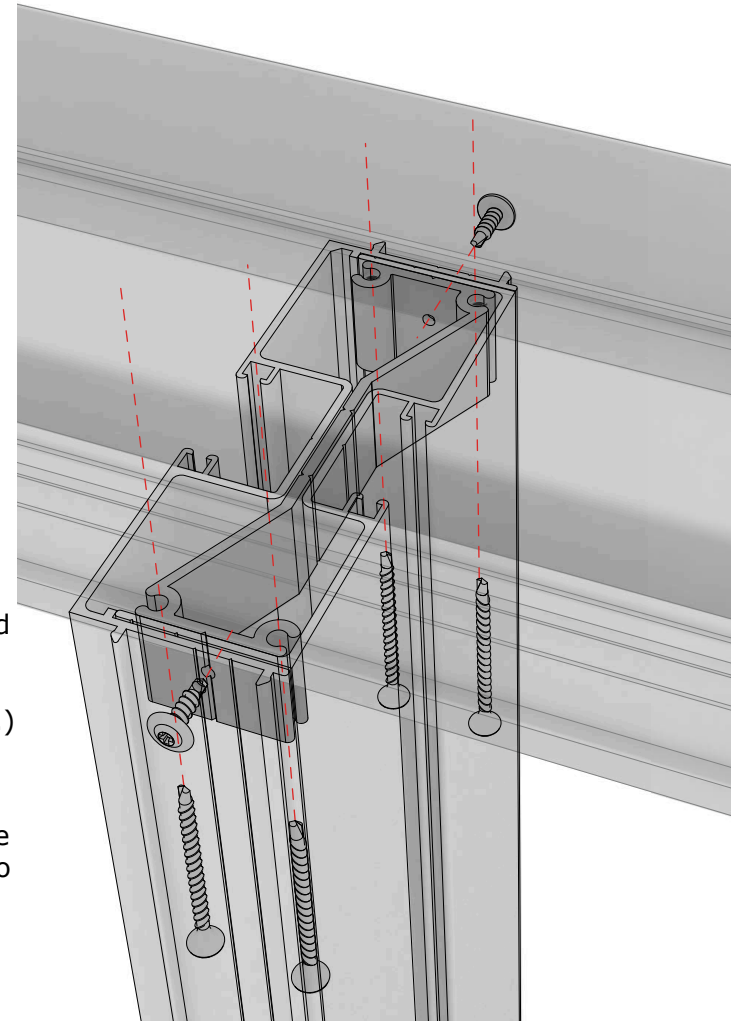

C210ST Clip

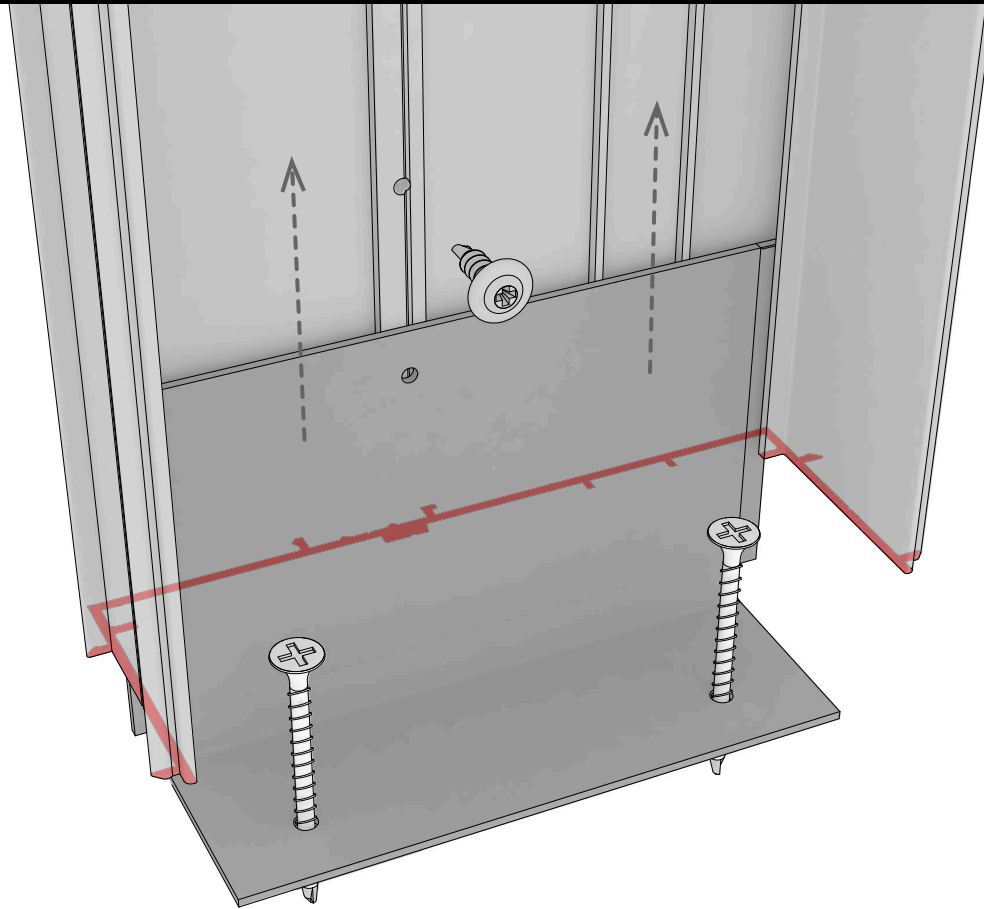

Slip the C210ST (floor clip) into the bottom of strike jamb behind extruded tabs and slide clip up so that the bottom of the clip and jamb align. Secure to jamb with 1/2" tek screw. Anchor the C210ST to the floor once in place. The method for anchoring is up to the installer.

C406ST clip

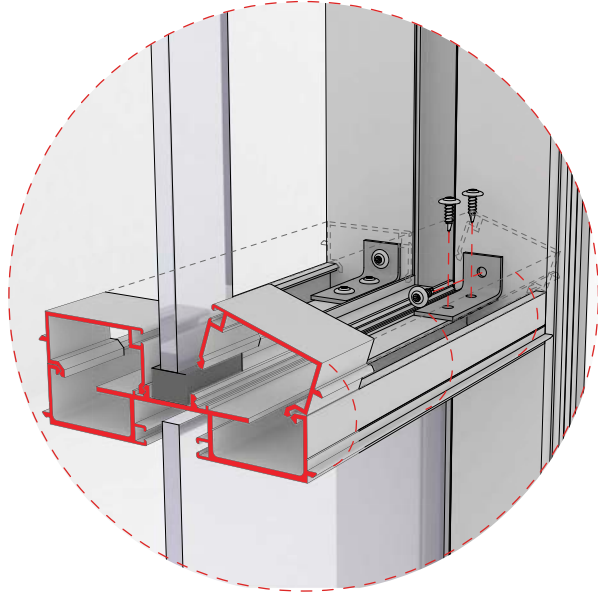

Attach C406ST (mini clip) to both sides and each end of the horizontal glazing member using 1/2" tek screws

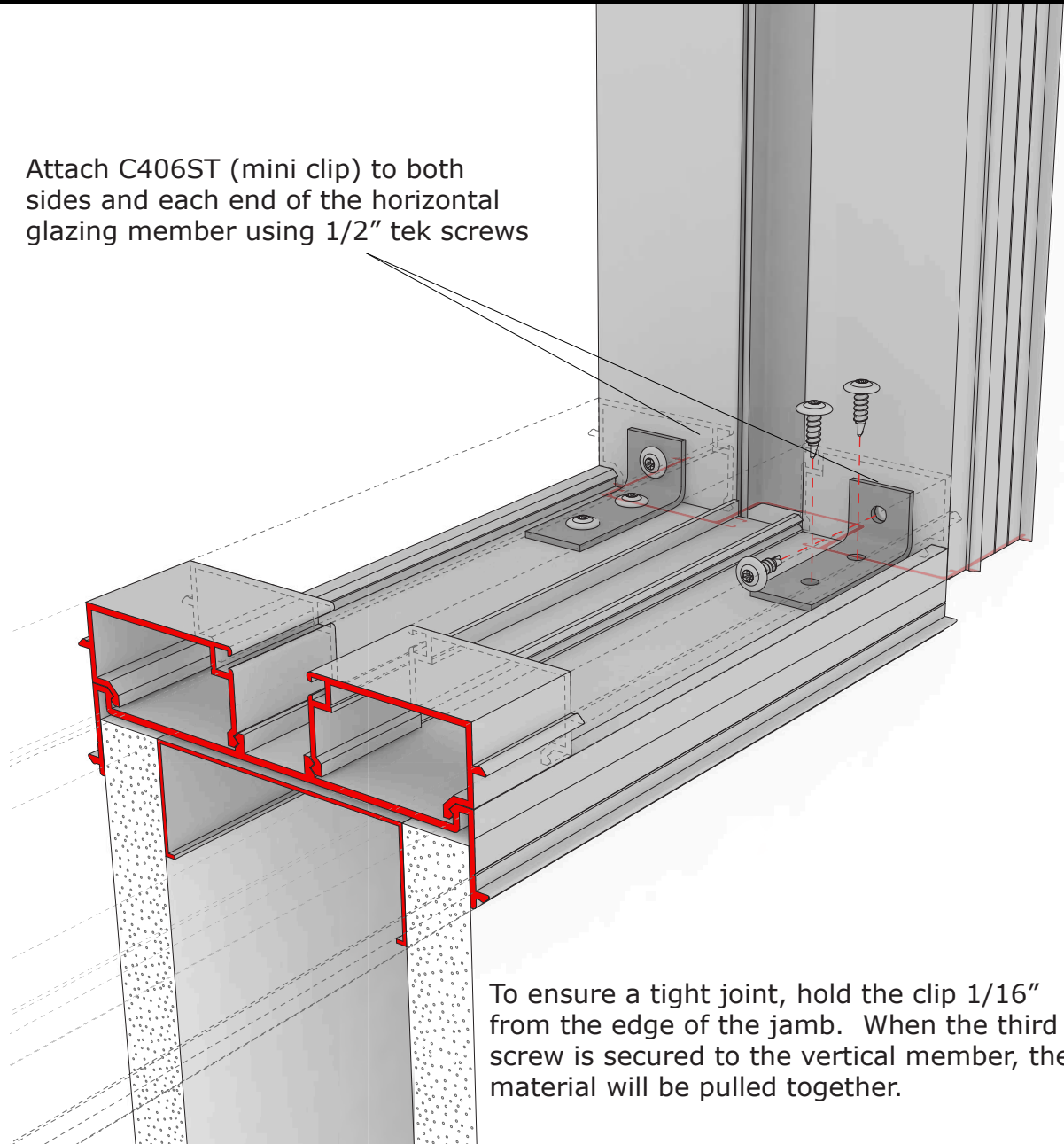

To ensure a tight joint, hold the clip 1/16" from the edge of the jamb. When the third screw is secured to the vertical member, the material will be pulled together.