

Installation Instructions: Type II Single Door Frame



Youtube Link



Tools Required: Tape Measure, Level, Plumb Bob,
File, Rubber Mallet, Drill, Miter Saw with carbide
tipped blade

Parts List

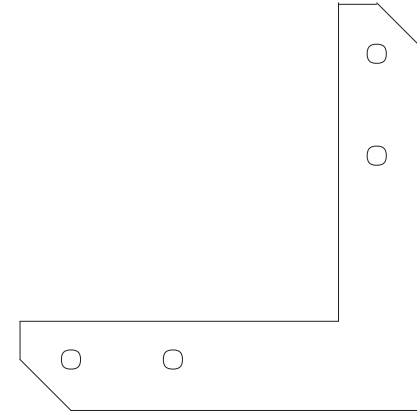
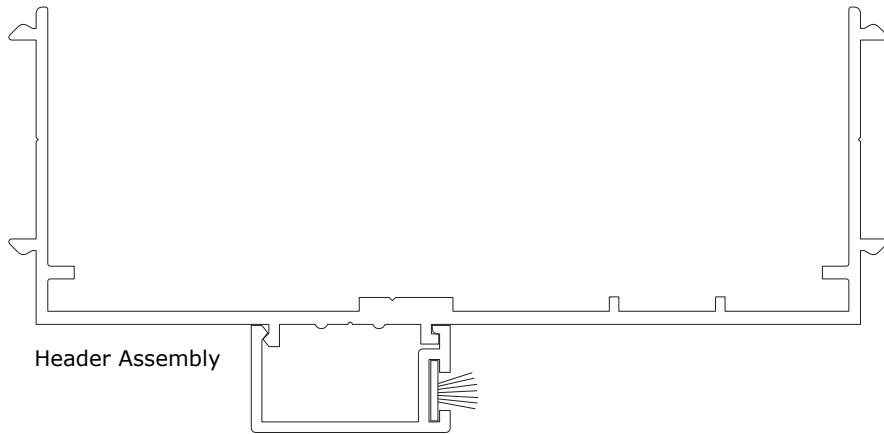

4 ea. C100ST Angle Plates
(header clip)

#8 x 1/2" Self
Drilling Wafer Head
Screws

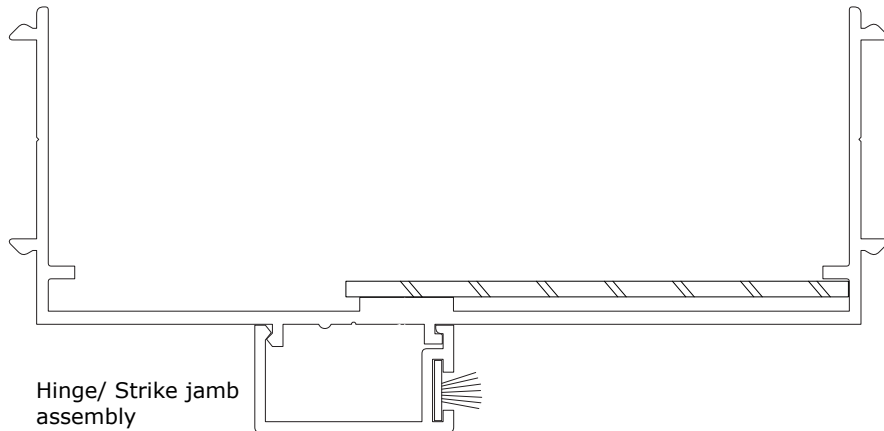
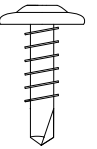

#6 x 1-5/8" Flat
Head Drywall
Screws

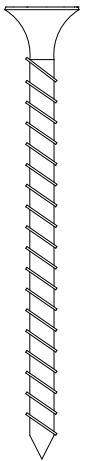

4 ea. Vertical jamb trim
and 2 ea. Header trim

Step 1

Check dimensions and square of rough opening.
Cut vertical jambs if necessary.

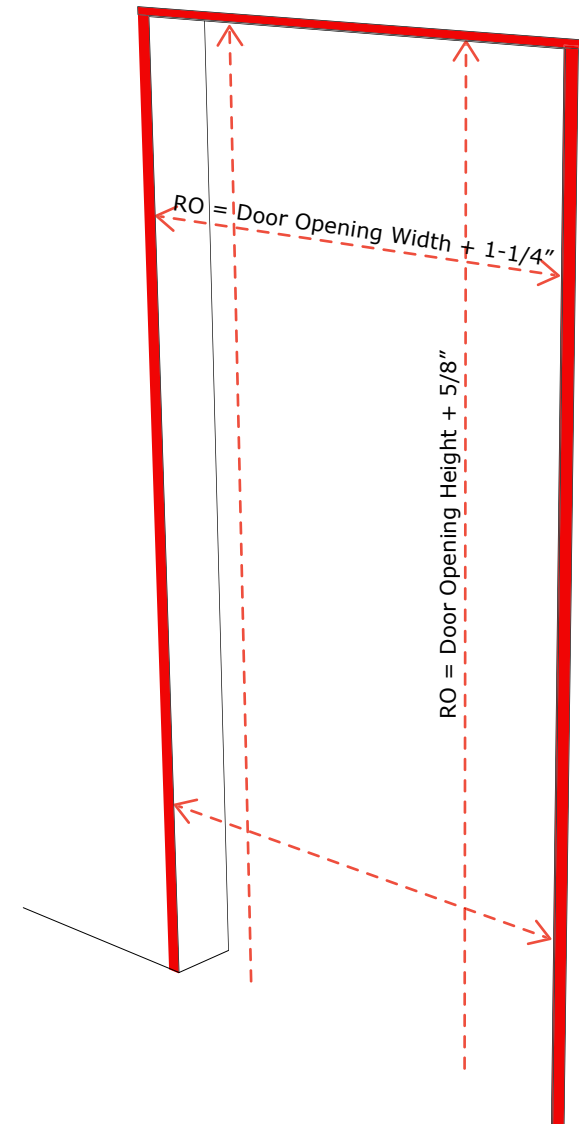
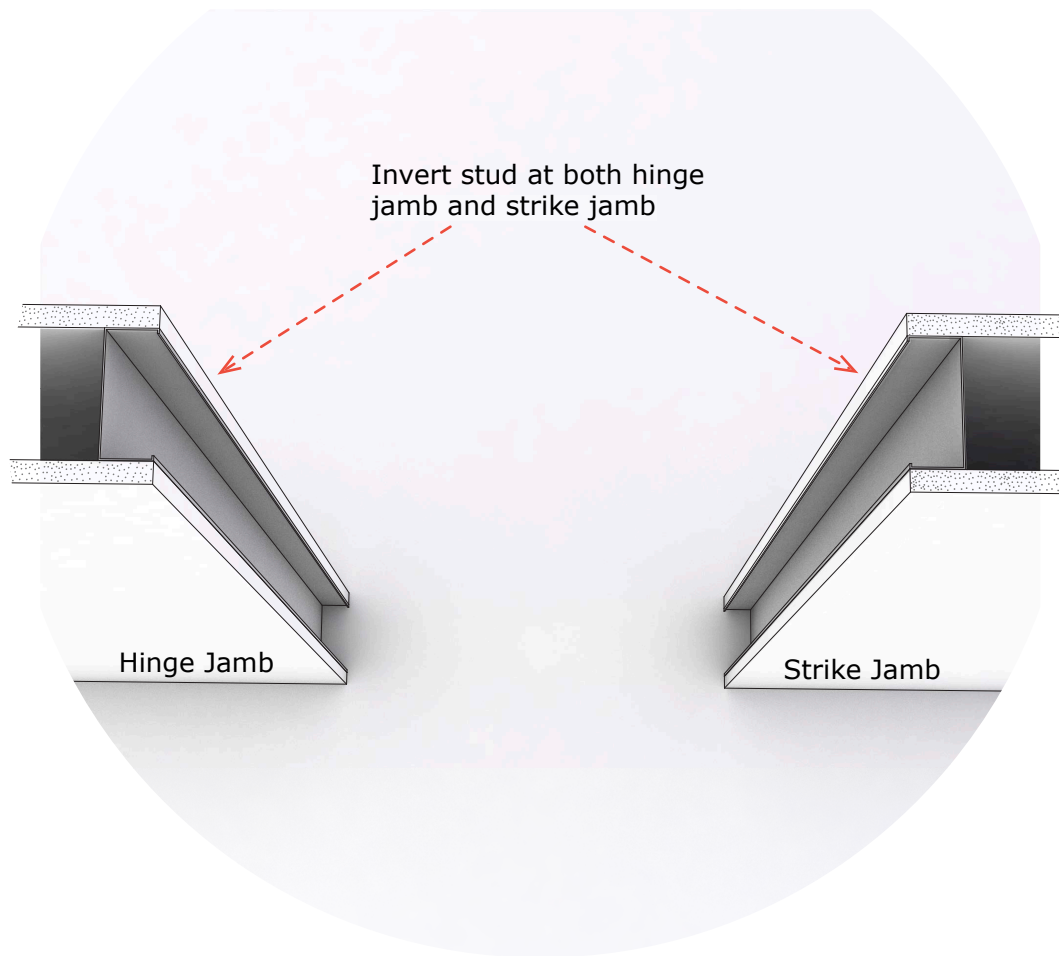

Step 2

Slip header and vertical jambs into opening.
Header will overlap jambs $\frac{3}{8}$ ".

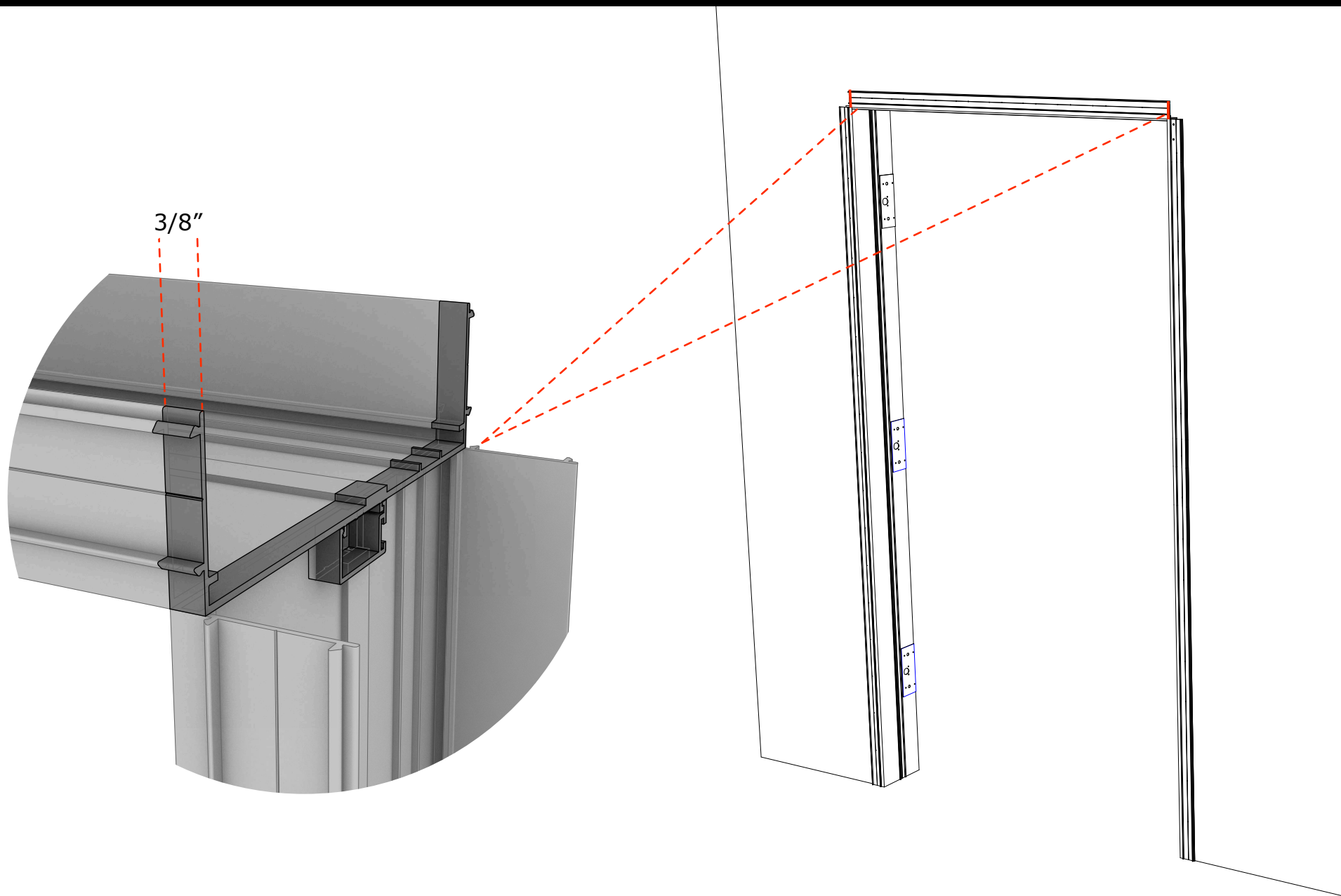

Step 3

Align to scheduled opening width and height, achieving equal wall capture on both jamb legs. Check level of header, square and plumb jamb legs.

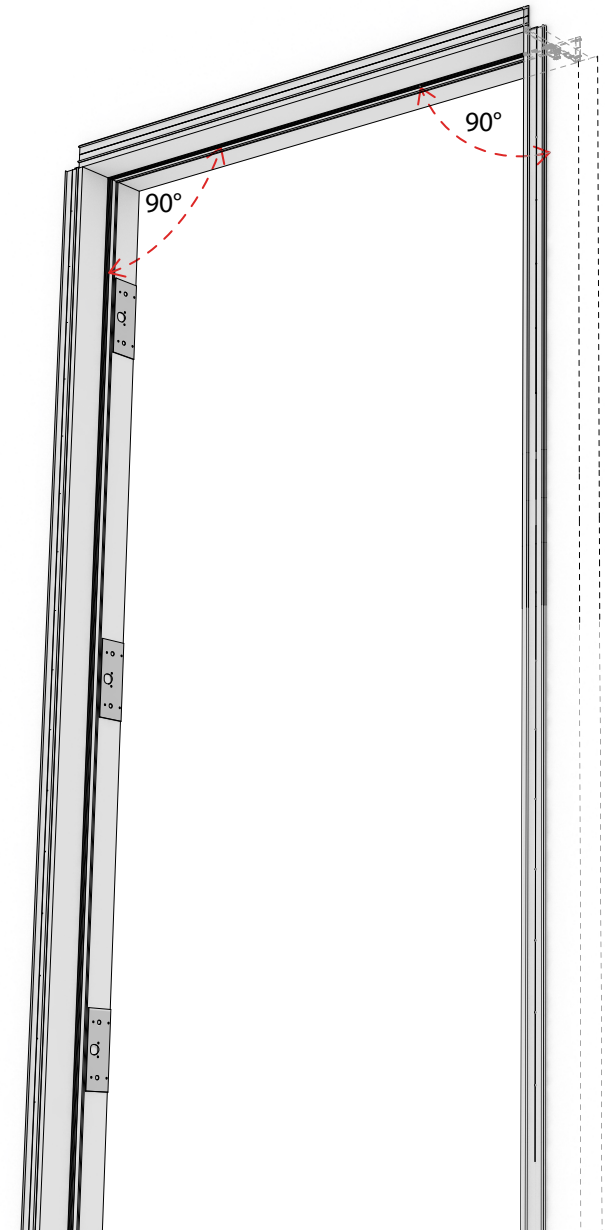
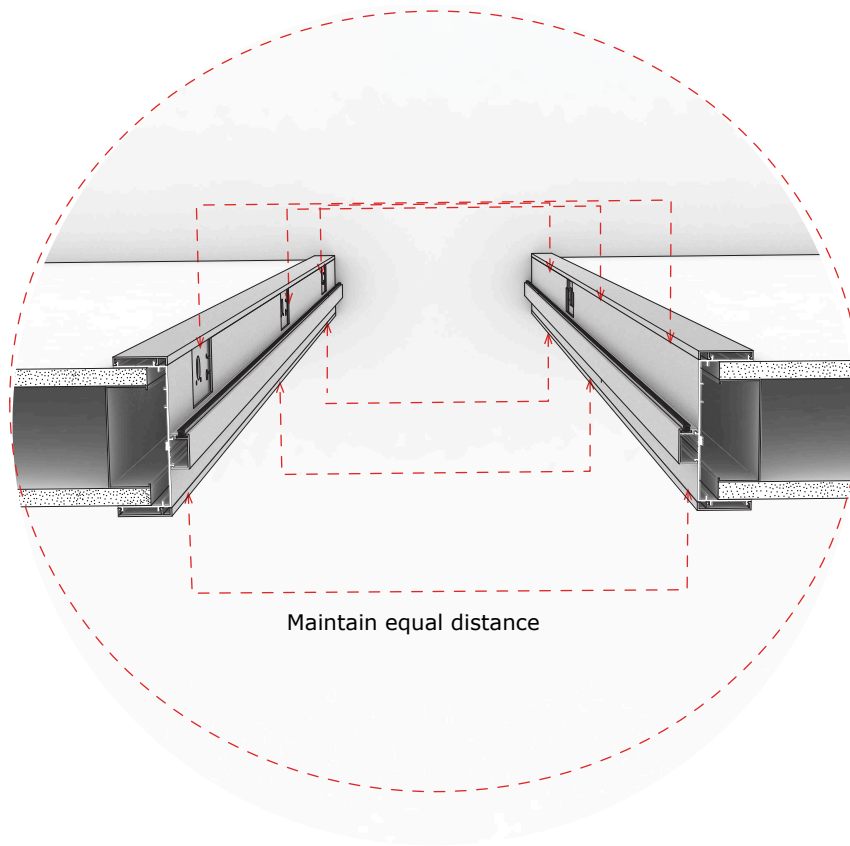

Step 4

Attach four flat angles (C100ST) with #8 x 1/2" wafer head self drilling screws at all faces of jamb and header.

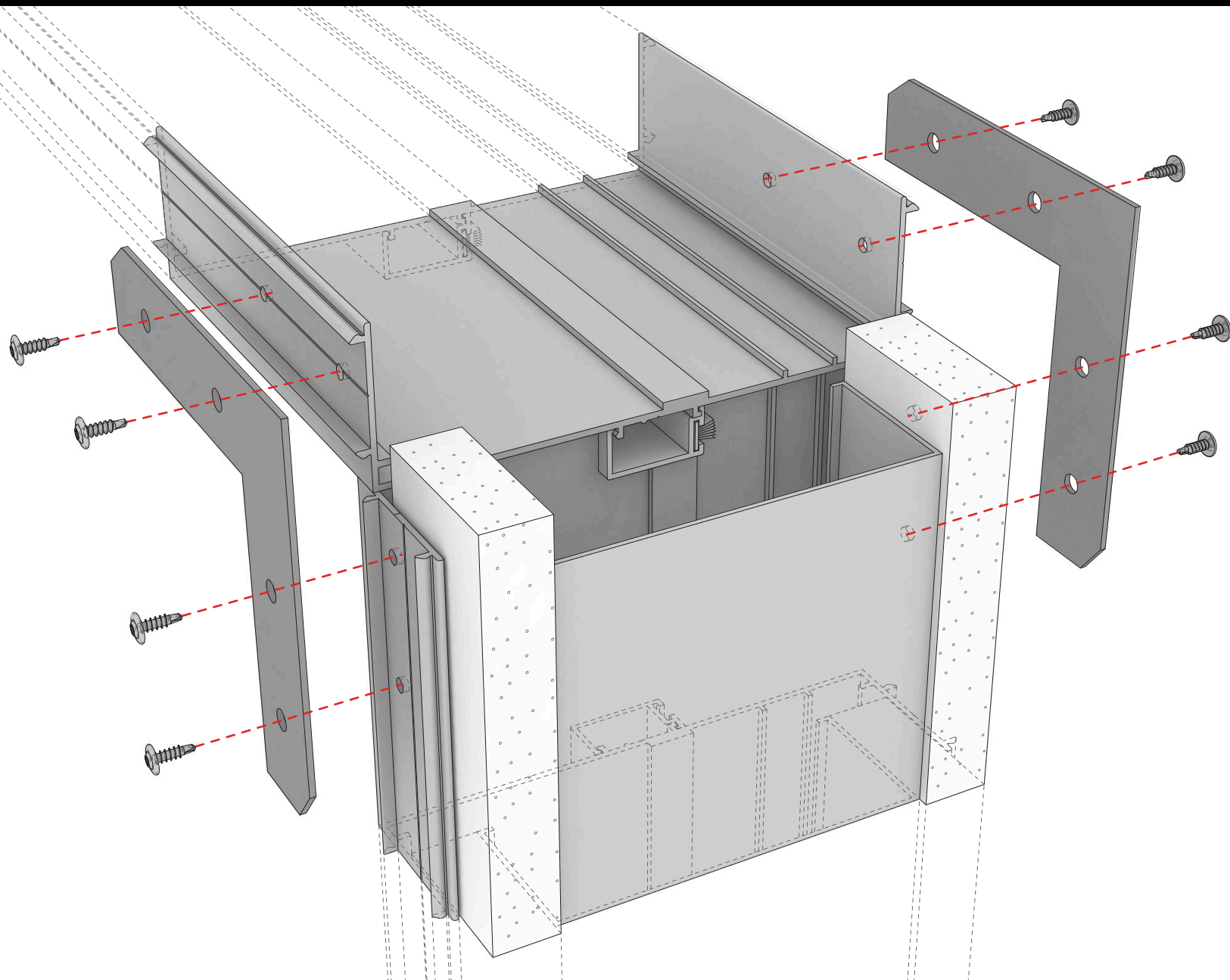

Step 5

Check square, plumb and opening width. Anchor jambs to wall using #6 x 1-5/8" drywall screws through round holes nearest top and bottom of each hinge and 12" OC elsewhere. Attachment should roughly align on both front faces.

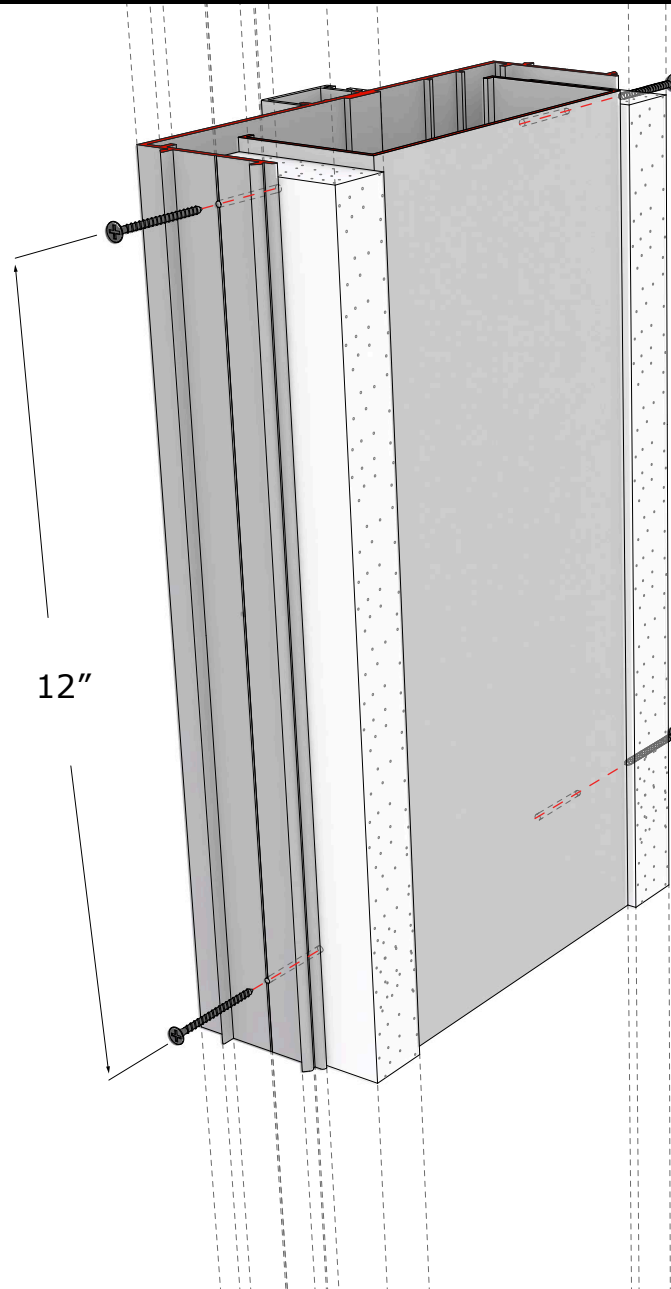

Step 6

Install trim by hooking outer leg on the receiver tab and tapping lightly with a rubber mallet toward the inner edge.

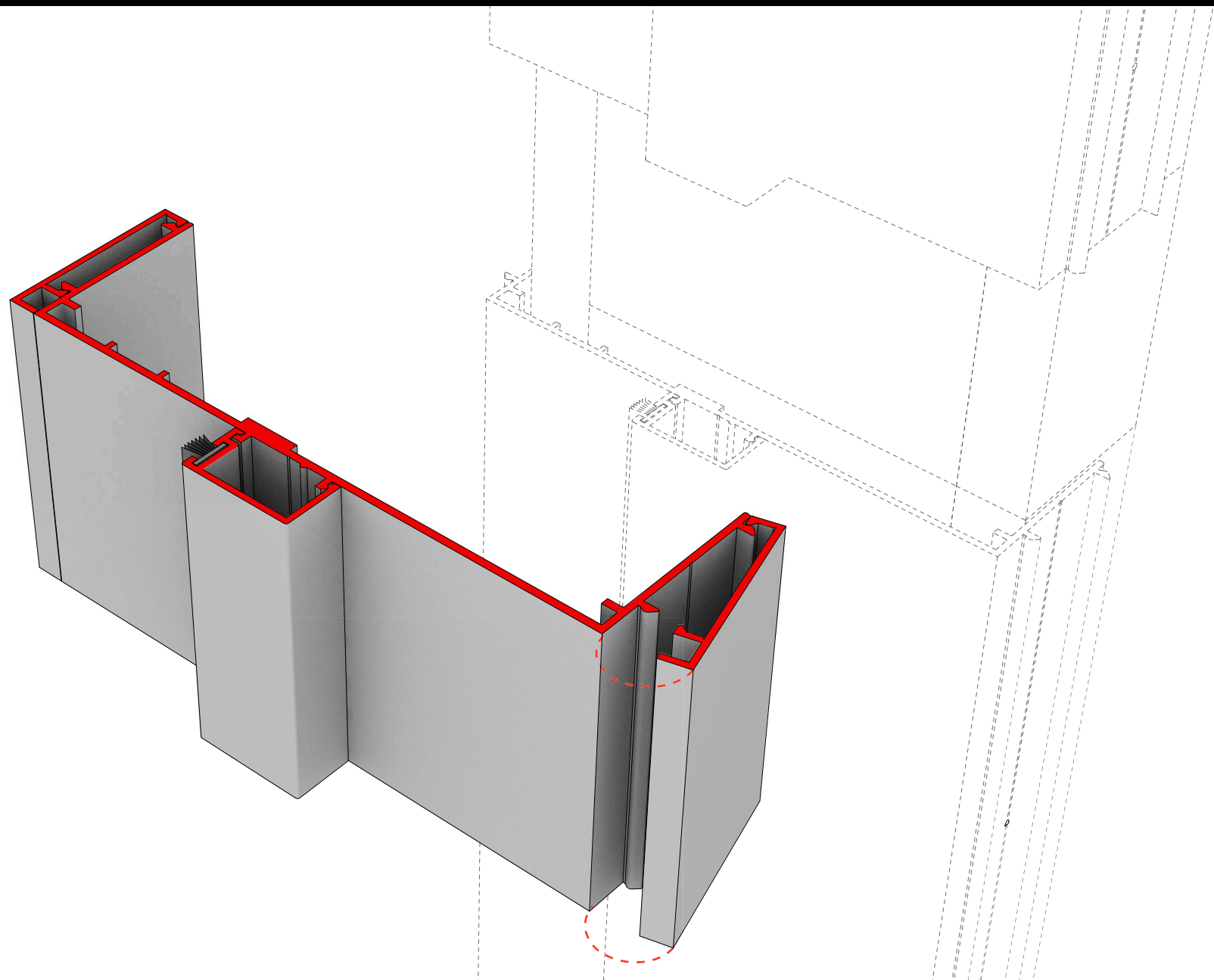

Step 7 (If Required)

Anchor hinge plates to metal studs using the provided #10 x 2" screws.

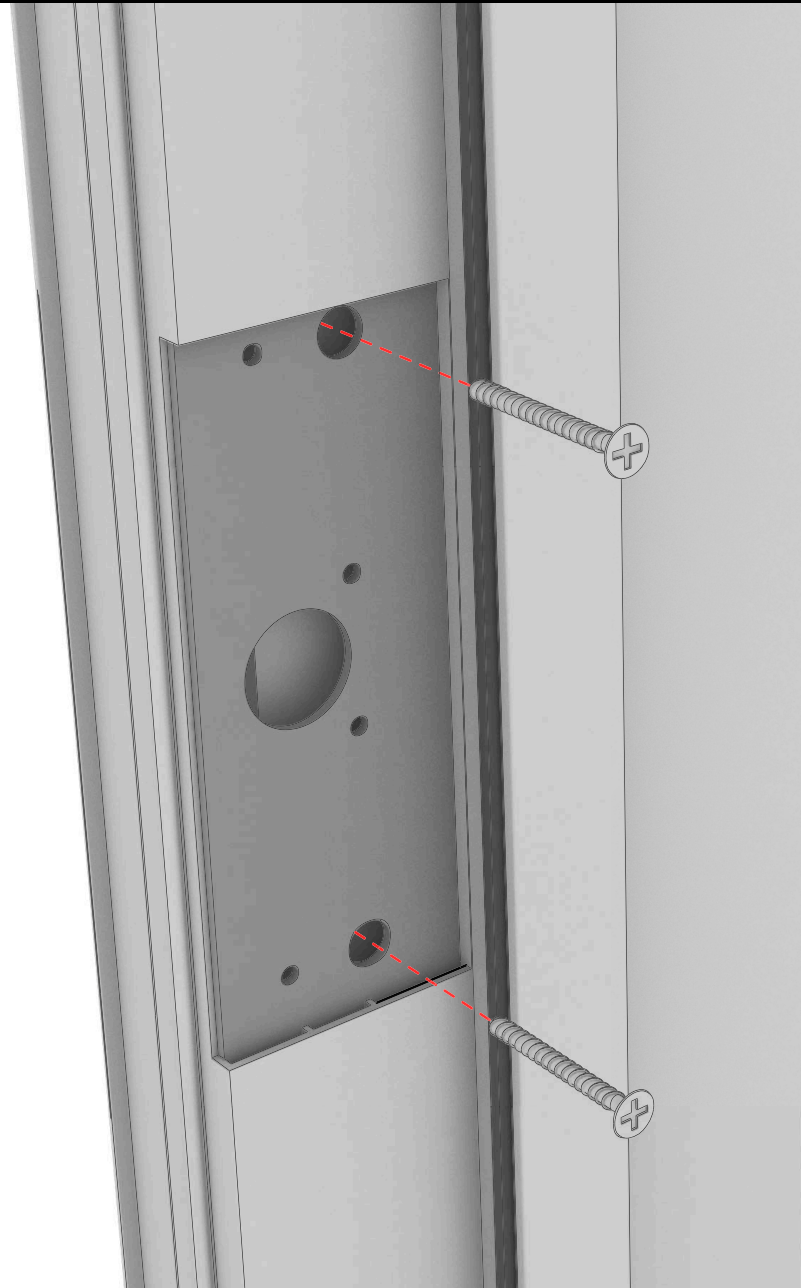

Note: 45 Minute fire rated frames require the attachment of the hinge backup plates to the wall framing